





20 000 782

- Bohrungsdurchmesser 32 mm
- Rosette 60 x 60 mm
- mit Kaltkennzeichnung

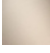

	Chrom	20 000 782-00
	Platin gebürstet	20 000 782-06
	Platin	20 000 782-08
	Dark Chrome	20 000 782-19
	Messing gebürstet (23kt Gold)	20 000 782-28
	Champagne gebürstet (22kt Gold)	20 000 782-46
	Champagne (22kt Gold)	20 000 782-47
	Dark Platinum gebürstet	20 000 782-99

20 000 782

mm [inches]

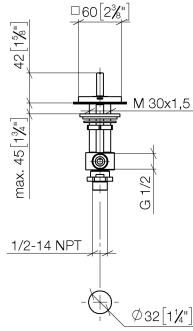

**Durchflussdiagramm**



**Zertifikate**

IAPMO\_4976 (5). WRAS\_2103001.

20 000 782

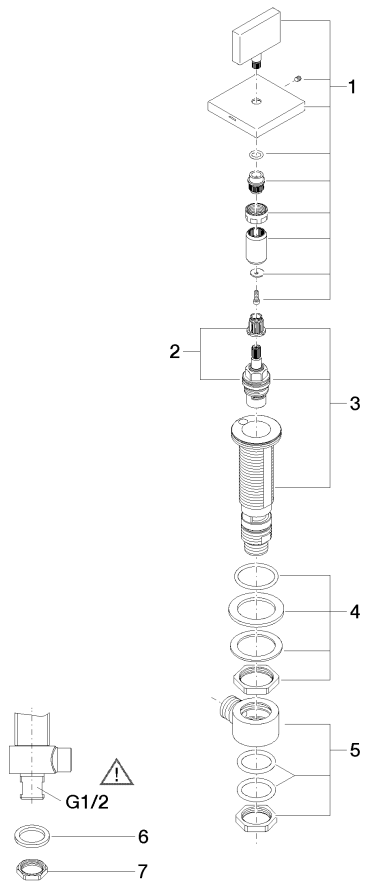

**Ersatzteilstückliste**

Nr.	Artikelnummer	Benennung	Verbaumenge	Lieferzeit
1	90 20 78 002 04-00	Griff ( cold )	1	10
2	90 90 03 133 00 90	Oberteil	1	2
3	04 17 11 058 33 90	Seitenteil	1	2
4	04 23 10 032 78 90	Befestigungssatz	1	2
5	04 17 11 023 10 90	Verteiler	1	2
6	09 30 11 059 90	Scheibe	1	2
7	09 23 10 012 90	Mutter	1	2